

# Instructions for EMPI 40K Dual Sets with Twist Linkage Part Number 43-4430

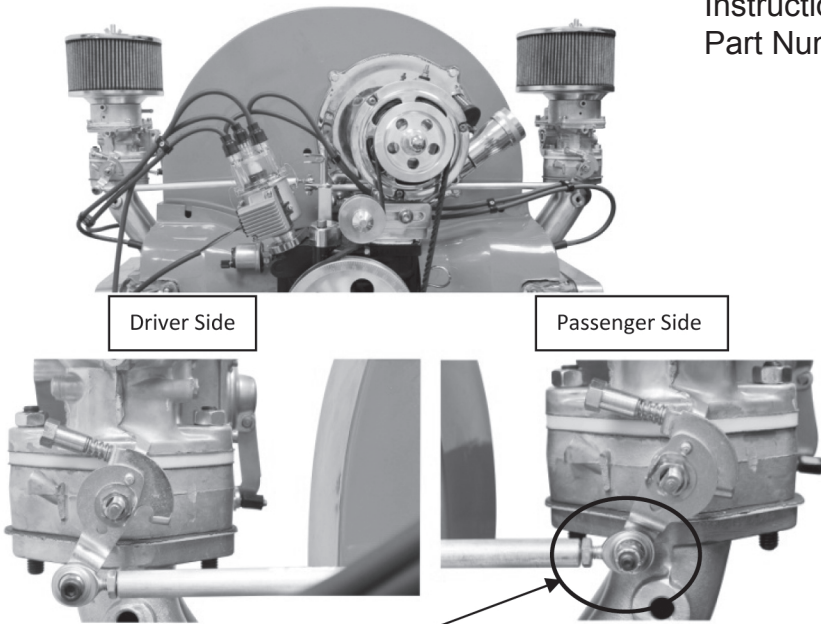

Install Linkage Arms to carburetors.  
 Install Left & Right Heims with jam nuts to Linkage Rods.  
 Install Linkage Stand on Engine Case using bolt provided or case stud if long enough.  
 Install flat washer, Linkage Pivot and 5/16 Lock Nut to Stud on Linkage Stand. Tighten only enough to limit vertical movement of Linkage Pivot.  
 Install Linkage Support Bracket. Black Button Head Allen w/lock washer to stand, S/S Allen w/flat washer to fan housing.  
 Install Linkage Rods to Linkage Arms (Black Allen Cap Screws) and Pivot (S/S Allen Cap Screw) and adjust.  
 Install Return Spring and check for proper operation.  
 Correct any binding or sticking before starting engine.  
 Start the engine and Synchronize carburetors.

Right & Left Linkage Arms are interchangeable. Passenger Side bolt must be installed from Inside – Nut on Outside

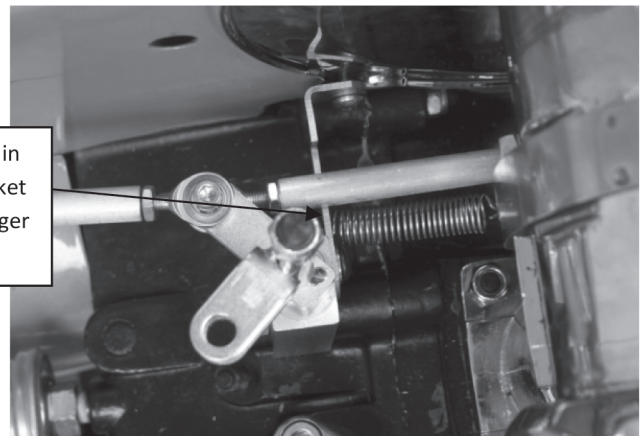
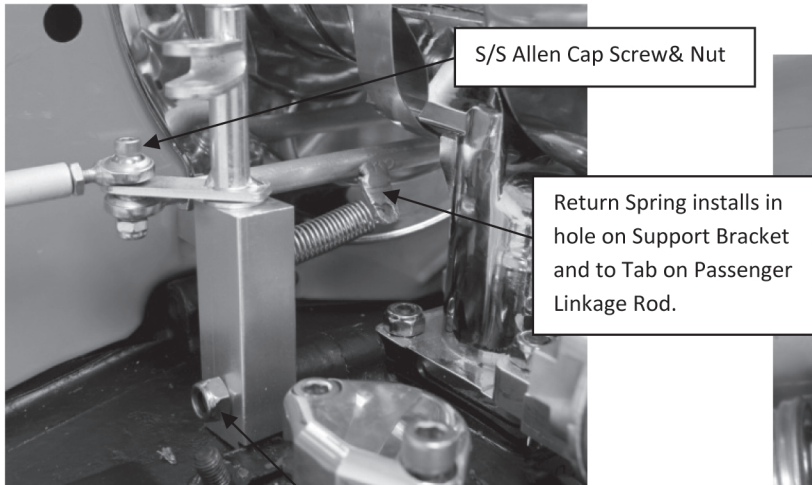

If your case has a long stud you are in luck!  
 If not, remove stud and use Bolt provided.

Support Bracket installs with groove UP, Black Button Head Allen & lock washer to the Stand – S/S Button Head Allen with flat washer to the Fan Housing.

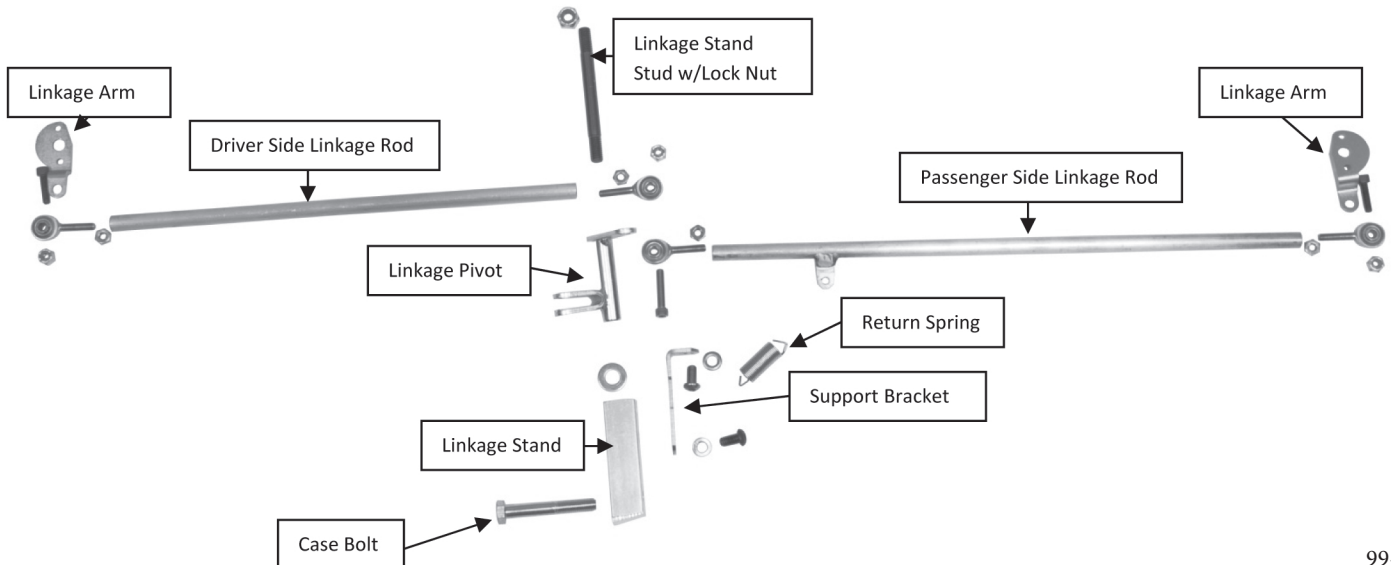

## PROCEDURE

1. Remove the air filter assemblies.
2. Disconnect the throttle linkage rods on **ALL** carburetors.
3. Turn "out" (counter clock-wise) the idle speed screw, on each carburetor, until the tip of the screw is flush with the casting. Check for binding or sticking of the throttle plates. With the idle speed screw in this position, the throttle plates should be completely closed in the bores. Correct any misalignment or binding **BEFORE** proceeding.
4. Turn "in" (clockwise) the idle speed screw, on each carburetor, until the tip of the screw just touches the carburetor lever. From this "contact" position, turn each idle speed screw exactly one (1) full turn "in". This is your preliminary set point.
5. Start the engine. **CAUTION: Be sure the loose throttle-rods are not interfering with other linkage components.**
7. To synchronize the carburetors, adjust each idle speed screw until a balanced airflow reading is obtained on the Syncrometer.
8. After the carburetors are synchronized, reinstall the linkage rods. If the linkage rod length is not correct the throttle lever position will be affected. To adjust linkage rod length loosen the right and left handed nuts and turn the rod shaft to shorten or lengthen the rod as necessary. **NOTE: When linkage rods are properly adjusted the Syncrometer reading will remain as originally set. When rods are adjusted, lock the rod nuts in place.**
9. If idle mixture and idle speed adjustments are not required, turn engine off and remove syncrometer. Replace air filter assemblies and this procedure is complete. If idle speed adjustment is necessary, see next step.